

CONSTRUCTION OF BADMINTON HALL AT ARMY PUBLIC SCHOOL SAMBA

CROSS SECTION OF TRUSS
SHEET NO-2

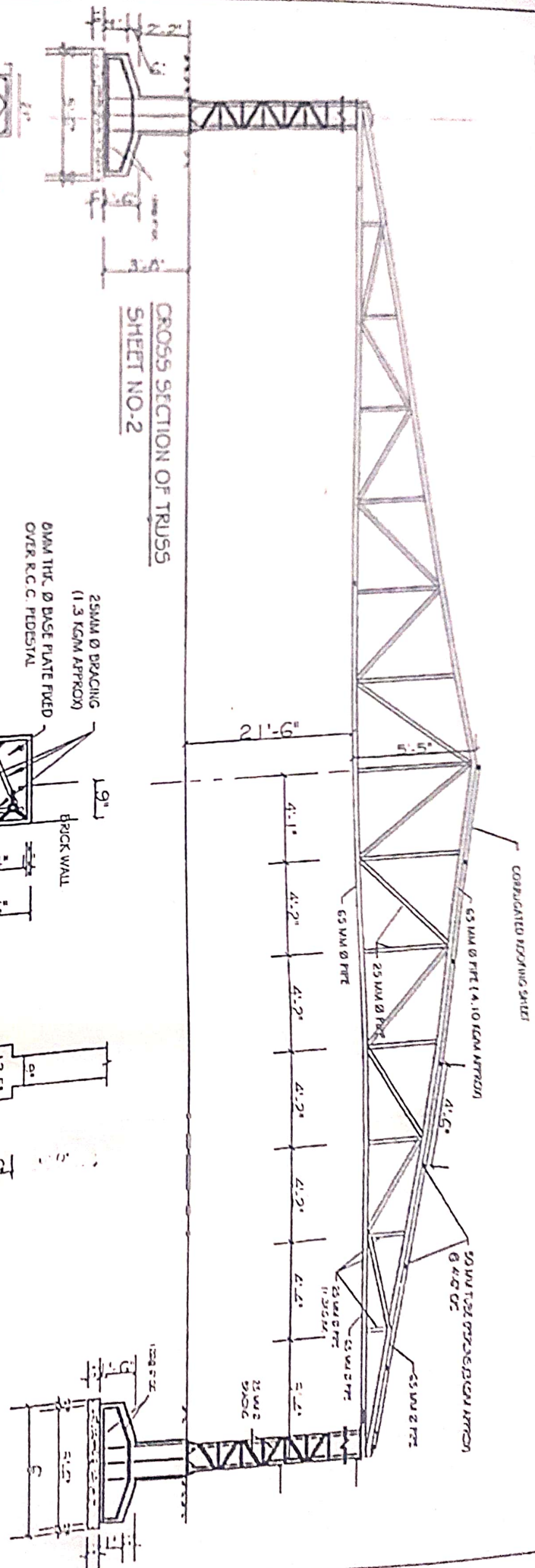

DETAIL OF R.C.C. COLUMN CI
(UPTO PLINTH LVL)



25MM Ø BRACING
(1.3 KG/M APPROX)
ØMM THK. Ø BASE PLATE FIXED
OVER R.C.C. PEDESTAL
50 MM Ø M.S. PIPE (3.85 KG/M APPROX)
BRACING PLATE
INNER SIDE OF COLUMN

DETAIL OF M.S. COLUMN

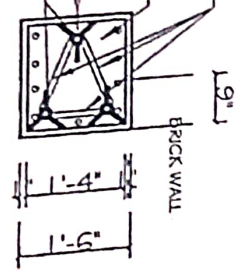

TYPICAL SECTION FOR 9" BRICK
WALL FOUNDATION

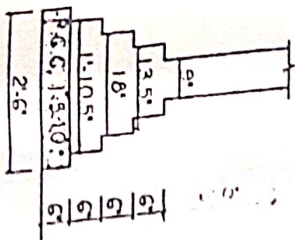

CONSTRUCTION OF BADMINTON HALL AT ARMY PUBLIC SCHOOL SAMBA

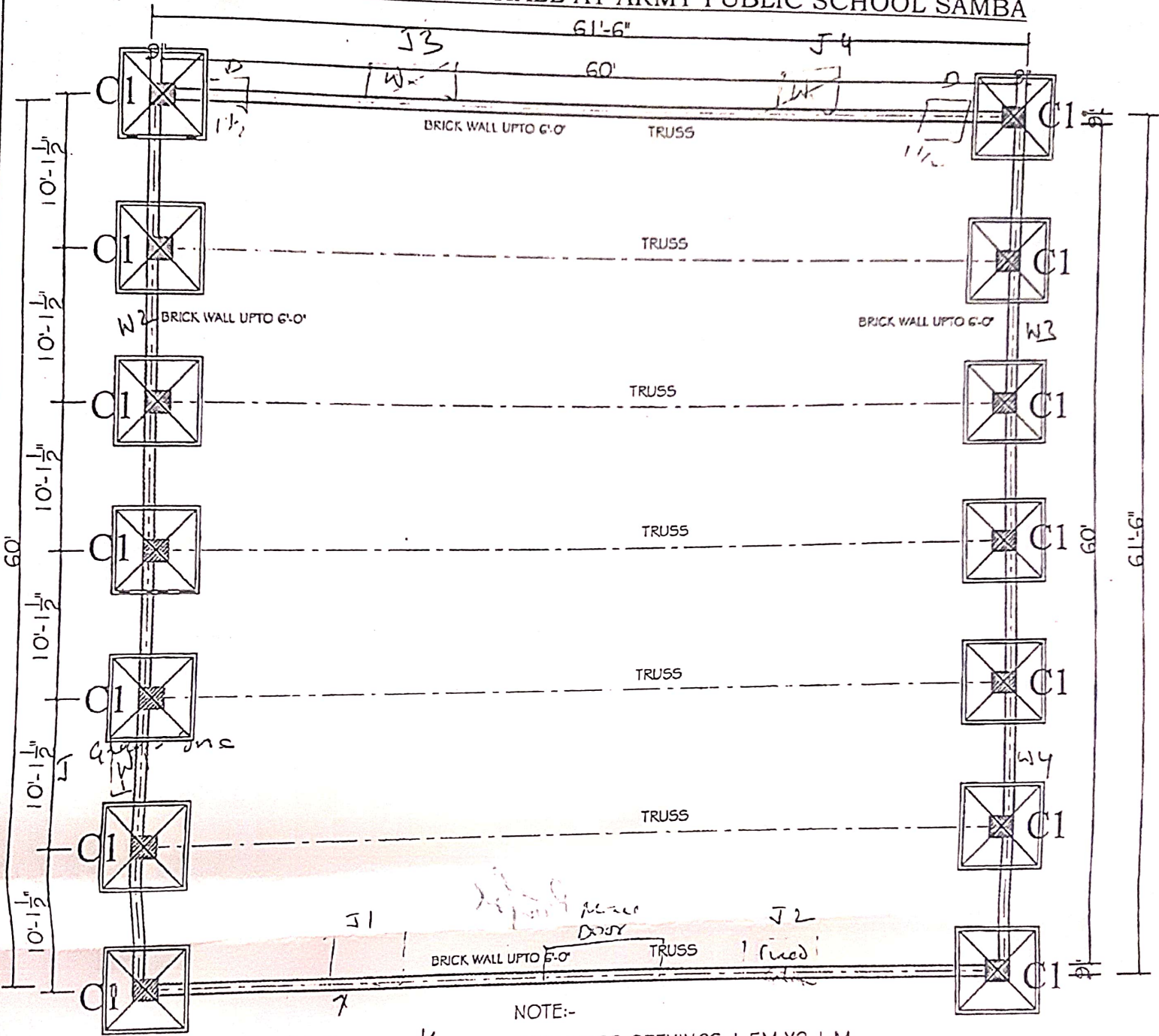

PLAN
SHEET NO-1

J = sliding wall
half jali

NOTE:-
2 NO DOOR OPENINGS 1.5M X 2.1 M
4 NO WINDOW OPENINGS 1.2M X 1.2 M